

[pro]master®

PROFESSIONAL

KEYGRIP

video monopod kit



Congratulations on your purchase of the ProMaster Key Grip Video Monopod Kit! You obviously have excellent taste.

Please read these instructions thoroughly to ensure proper operation of your new monopod kit, even if you have used other monopods before. With proper use and care, the Key Grip will provide many years of service.

Be sure to refer to the main parts diagram as well as each of the figures throughout the pages as you read. When a specific part of the Key Grip is referred to in **red**, you will find it shown on the main parts diagram and/or in the referenced figure.

Parts Diagram:

Video Head

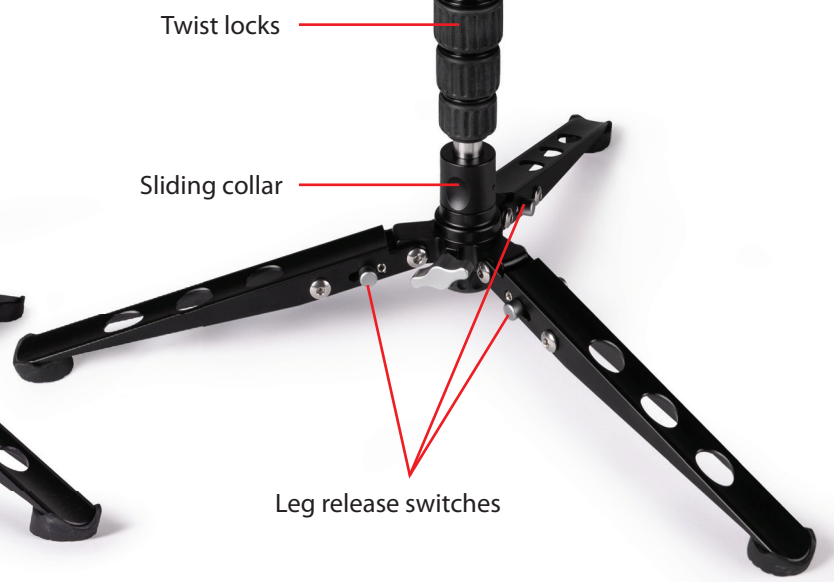

INITIAL SETUP

When you first unbox the Key Grip Monopod, it will be stored in its padded fabric case. This bag provides a great way to store and transport the monopod, and its interior pouch is a convenient place for keeping accessories. Upon removing the monopod from the bag, you will find the **control handle** and **quick release plate (QR plate)** attached to the **video head**. These items will be discussed later in this manual.

After removing the monopod from its bag, begin by unfolding the **3-leg base**. As you pull each leg down its **leg release switch** will snap into its locked position, preventing the leg from folding back upward. With the three legs unfolded, you can now set the monopod down and it will stand on its own. Loosen the **tilt adjustment knob** to bring the head to its standard position parallel with the ground (the 0° mark on the head's **tilt scale**). Tighten the knob to secure it in place.

*To return the **3-leg base** to its folded position for storage, slide each **leg release switch** away from the center of the base and hold it as you fold the leg upward.*

Next, we want to make sure that the **grub screw** is properly tightened so the **video head** is securely attached. Unscrew the **handle end cap** from the head's **control handle**, and you will find a set of hex keys stored within the handle. Two **4mm hex keys** can be used for multiple functions discussed later in this manual; the smaller **2.5mm hex key** is used for **grub screw** adjustment. Notice a small, silver-colored bolt on the underside of the **monopod platform**. This is known as a **grub screw** and it prevents the head from detaching by placing force against its base. Use the **2.5mm hex key** to ensure that the screw is tight. If it is loose, first take ahold of the **video head** and make sure its **pan lock knob** is tight. Now rotate the head against the **monopod platform** in a clockwise direction to ensure it is tight. Finally, tighten the **grub screw**.

*Note, the **grub screw** is typically only used when removing the **video head** or when attaching a different type of head to this monopod. Never operate the monopod or head unless the **grub screw** is tight.*

ATTACHING YOUR CAMERA (USING THE QUICK RELEASE PLATE)

Loosen the **QR knob** on the **video head** and remove the **QR plate**. In most cases you will be using the **1/4"-20 mounting bolt**; however, the larger **3/8"-16 mounting bolt** may be necessary with some gear. Professional lenses and cameras often have two mounting holes, for which you can use both the **1/4"-20 bolt** and **3/8"-16 bolts** simultaneously. If you prefer to remove one of the mounting bolts, remove the **soft cover** from the bottom of the **QR plate**, slide the bolt out, and replace the **soft cover**. When mounting any camera or lens, slide the bolt(s) within the slot in the **QR plate** to achieve the best positioning. The plate should be mounted parallel to the direction of your lens. Use one of the **4mm hex keys** stored in the control handle to tighten the mounting bolts. These bolts can also be tightened with a flathead screwdriver. Now place the **QR plate** (with your camera attached) into the top of the

video head and tighten the **QR knob** to hold it in place. When mounting your camera to the head, slide the **QR plate** back and forth within the **QR platform** to find the best balance point before fully tightening the **QR knob**. Note the location of the plate using the numbered scale on the **QR platform** for future, repeatable mounting in the same place. Notice that the **QR knob** is repositionable—you can pull outward on it, rotate it to a new position, and let go of it. This will change the phase position of the knob without loosening or tightening it. This repositionable feature allows you to set the **QR knob** to the most convenient resting place.

The **QR plate's anti-twist pin** is designed for an anti-twist hole found in the bottom of some cameras and lens mounting rings. If your camera or lens does not have this hole, the spring-loaded pin will retract on its own as the **QR plate** is installed. If preferred, you can remove the pin by unscrewing it from the bottom of the **QR plate** with a flathead screwdriver.

On the bottom side of the **QR plate** you will notice two protruding **safety bolts**. These prevent the **QR plate** and your camera from sliding off the top of the **video head** if the **QR knob** is loosened accidentally. The safety bolts can be removed if you choose using the **2.5mm hex key** stored in the **control handle**. Removing the bolts will allow the **QR plate** to slide into the top of the **video head** more easily, but will eliminate the safety feature. We do not recommend removing the **safety bolts** from the **QR plate**.

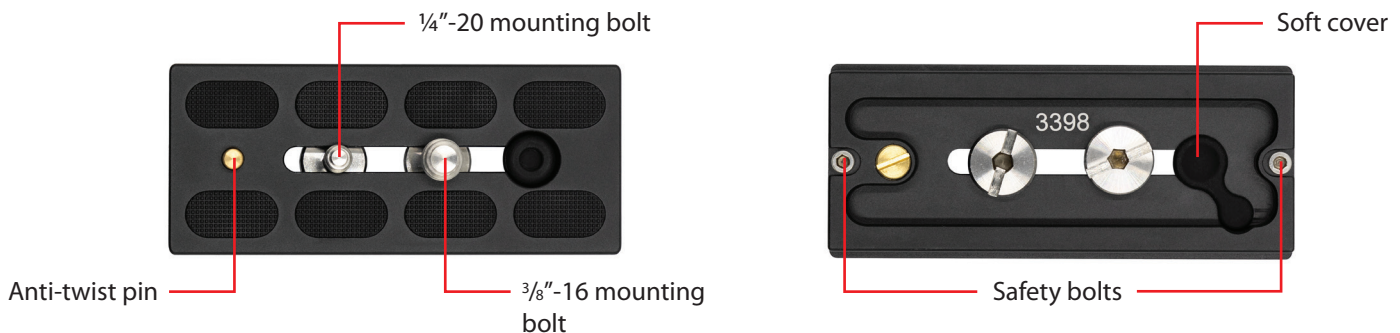

REMOVING AND MOUNTING THE HEAD

You may choose to remove the included **video head** and install a different type of head. Or you may wish to mount the Key Grip **video head** to a different monopod, tripod, or grip item.

Locate the **2.5mm hex key** stored within the Key Grip's **control handle**. Use the **hex key** to loosen the **grub screw** found on the underside of the **monopod platform**. Ensure the **pan lock knob** on the head is tight. Take ahold of the **video head** with one hand and the upper section of the monopod with your other hand. Turn these two parts counterclockwise to loosen them from each other. Continue turning the head until it is fully released from the monopod.

You can now mount a different head to the **3/8"-16** connection on the **monopod platform**. Once the head is installed, be sure to re-tighten the **grub screw** to secure it in place.



USING THE VIDEO HEAD

Your Key Grip Monopod Kit includes a precision machined aluminum **video head**. It is a 2-way head, meaning there is control for the tilt adjustment and separate control for the panning motion. An extendable **control handle** with a soft, comfortable grip helps achieve smooth panning and tilting motions. The **QR platform** can also be set up in various orientations for front-to-back **QR plate** mounting or side-to-side. Each of these are explained below.

Using the Control Handle

The Key Grip **control handle** is extendable. To unlock the handle in order to extend it, hold the grip and twist to the left. Then, pull back to bring the handle to its full extension, and twist to the right to lock it in place. Reverse this procedure to return the handle to its standard length.

To adjust the handle's angle, loosen the **handle release knob** approximately 1 full turn. Reposition the **control handle** to a comfortable angle, hold it in place and tighten the **handle release knob** to secure its position. Two facing stainless steel rosettes prevent the handle from slipping out of position during use.



Pan and Tilt Adjustments

The Key Grip **video head** has an independent base panning control with a laser-engraved scale for precise rotational movements. Loosen the **pan lock knob** and you can rotate the entire head 360° around its base.

*Please note, the **pan lock knob** is indeed a lock and does not offer any type of tension adjustment. This head uses static drag for panning. Do not attempt to apply tension using the pan lock knob or you may damage the mechanism. This knob should only be set to a locked or unlocked position but nothing in between.*

The **tilt adjustment knob** controls the tension of the head's tilt adjustment. When this knob is fully tightened it will lock the tilt axis, thereby holding it in a fixed position. When loosened, the head can be tilted up to 90° forward and 60° backward. (The head features an etched scale with degree markings to aid in making precise, repeatable movements.) The **tilt adjustment knob** allows for some tension control. This means that you can adjust the knob between its fully tightened and fully

loosened positions to apply varying amounts of tension. Doing this will slow down the movement of your camera and can help achieve smoother motions. Greater tension can be beneficial when working with heavier camera rigs.

Changing the Direction of the QR Platform

In its default setup, your camera mounts to the head in a front-to-back sliding direction. This can be changed to a side-to-side direction, which is particularly useful for mounting a camera with an L-bracket or cage attached. With the **QR plate** removed from the head, notice the large, silver bolt in the top center of the **QR platform**. Remove this bolt using one of the **4mm hex keys** stored in the **control handle** and lift the **QR platform** away from the head. You can reposition the platform in any one of 4 positions at 90° intervals. Replace and tighten the bolt to re-fasten the **QR platform** to the head.

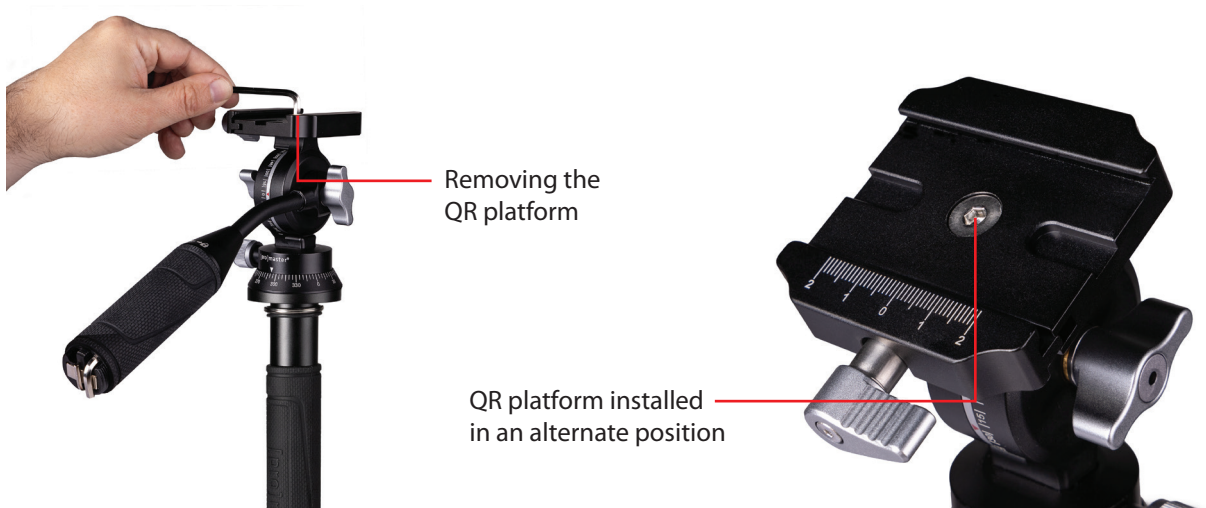

EXTENDING AND COLLAPSING THE MONOPOD

The Key Grip Monopod has 4 sections. This means you have 3 extendable monopod sections and one fixed section which is connected to the **video head**. The monopod sections can be opened or collapsed in any order. For the best stability we recommend opening and using the monopod sections from biggest (largest diameter) to littlest (smallest diameter). In other words, extend the largest sections first and proceed in descending order. It is easiest to adjust the **twist locks** with one hand while holding the monopod's **soft grip** with the other.

Wrap your hand around one of the **twist locks** and twist it in a clockwise direction. This will unlock it. $\frac{1}{4}$ turn is all that is necessary to open each **twist lock**. Do not rotate the lock any further; if you rotate a **twist lock** too far, it may become unintentionally disassembled. Once the **twist lock** is opened, pull on the monopod section(s) below to extend that section to the desired length. Then, turn the **twist lock** in the opposite direction to tighten it and hold the section in place. You do not need to apply very much force due to the design of these locks. Please be sure not to overtighten the **twist locks** or you may have difficulty opening them later.

As you practice extending the monopod you will notice that when the monopod is collapsed you can take ahold of just one **twist lock** with your fingers, or as many as all 3 **twist locks** with your entire hand at once. By taking ahold of all 3 **twist locks** at once and rotating them to an unlocked position, you can quickly open your monopod for use at full height.

You do not need to extend a section all the way until it stops before tightening a **twist lock**. You can choose to stop the monopod section anywhere along its length of travel and then tighten the **twist lock** to hold it there.

USING THE SLIDING COLLAR

The monopod's **3-leg base** has a **sliding collar** which provides additional versatility. In its default, down position, the monopod is held upright within the **3-leg base**. This provides good stability and, when used on level ground, allows for even panning with the **video head**. Hold the **release button** and move the **sliding collar** up to reveal a ball joint which allows you to move the monopod freely and achieve a variety of angles. With the collar in its up position, you can adjust the **base tension control knob** to tighten or loosen the tension on the joint. When using the 3-leg base with its **sliding collar** in the down position, the **base tension control knob** should be fully tightened for optimal stability.

*Note: never leave the monopod unattended with your gear attached, even with the **sliding collar** in its down position.*

INSTALLING MONOPOD FEET

This kit is shipped with the monopod's **3-leg base** attached. A **soft foot** is installed on the bottom of the **3-leg base** which can be used when the base's legs are folded up. This foot has a small O-ring in its threads to help prevent it from becoming loose unintentionally. For a more lightweight, traditional monopod setup, remove the **3-leg base** by holding it in place (stepping on it is a fine approach) and turning the monopod counterclockwise. Once the base is removed, a common $\frac{3}{8}$ "-16 threaded port is revealed at the bottom of the monopod. This port can accept the **soft foot**, or the **stainless-steel spike** included in the fabric case's accessory pouch. The spike is useful outdoors, especially in loose gravel, snow, and ice. The **2.5mm hex key** stored in the control handle makes it easy to remove the **stainless-steel spike**—simply insert it through the hole in the spike and use the hex key for leverage as you turn counterclockwise.



Soft foot



Stainless-steel spike

CONVERTING TO A GROUND-LEVEL SETUP

Directly above the monopod's **soft grip** is a joint between the upper and lower portions of the monopod. The upper portion can connect directly to the **3-leg base** for use at ground level. First, separate the upper portion by unscrewing it from the lower portion of the monopod: hold the lower portion at the **soft grip** and, with your other hand, rotate the upper portion counter-clockwise and unscrew until separated. Next, separate the monopod's lower portion from the **3-leg base** by grasping the **soft grip** and rotating the monopod counter-clockwise until it is fully unscrewed from the base. It helps to step on one leg of the base to hold it in place while removing the monopod. Finally, connect the upper portion to the **3-leg base** by mounting it to the base's $\frac{3}{8}$ "-16 **connection**. Note that the **sliding collar** can be used in either position when the kit is set up at ground level.



TIPS FOR USE

1. PERIODICALLY CHECK THE GRUB SCREW

The grub screw keeps the head securely connected to the tripod and prevents these parts from accidentally becoming loose. Check the grub screw periodically along with the head and column to ensure they are connected tightly.

2. EXTEND THE THICKEST MONOPOD SECTIONS FIRST

When you are using the Key Grip without all 4 monopod sections fully extended, be sure to use the largest section first. In other words, work your way down from the top of the monopod before extending the next, smaller section.

3. MAKE ADJUSTMENTS WITH YOUR GEAR IN MIND

The Key Grip provides several ways to customize its operation to best suit your rig, starting with a long QR plate which lets you balance your equipment before using the monopod. Depending on the size and weight of your equipment and the type of movements you will be making, you may prefer to use the control handle in its extended or collapsed position. Finally, adjust the tilt adjustment tension and base tension (if using the 3-leg base with its sliding collar in the up position) to best suit your preferences.

PRECAUTIONS

1. The Key Grip Video Monopod Kit is not water resistant. Do not submerge it or expose it to heavy rain or snow. If the monopod does get very wet, you may need to disassemble the unit to dry and clean it. Contact customer support at ProMaster for instructions about how to do this properly.
2. Never expose the Key Grip to salt water.
3. Periodically check to ensure various parts of the Key Grip are tight or adjusted properly, such as the grub screw, the control handle, the bolts on the 3-leg base, and the foot.
4. Never leave the monopod unattended. The monopod's 3-leg base provides an excellent platform that has advantages in many situations over using a traditional foot. It is not a tripod, however; as the monopod is extended, the center of gravity moves higher and stability is reduced. Never walk away from the monopod while your gear is attached.
5. Don't touch the metal parts of the monopod with bare skin in cold temperatures. Wear gloves. A great set of photo gloves can be especially helpful in cold weather.
6. Always make sure the QR plate is securely attached to your camera before mounting it to the Key Grip, and make sure that the QR knob is fully tightened before operating the head.
7. Don't rub it in. When other people see you using the Key Grip and appear jealous, please direct them to a friendly neighborhood ProMaster retailer or www.promaster.com so they can enjoy a similar experience.

ONE YEAR UNCONDITIONAL WARRANTY

If for any reason, this ProMaster product fails with ONE YEAR of the date of purchase, return this product to your ProMaster dealer and it will be exchanged for you at no charge. ProMaster products are guaranteed for ONE FULL YEAR against defects in workmanship and materials. If, at any time after one year, your ProMaster product fails under normal use, we invite you to return it to ProMaster for evaluation.

Code 77806

Made in China

WWW.PROMASTER.COM